

FP Series Sealed Ultra Miniature Pushbutton Switches



A

Pushbutton

Features/Benefits

- Vertical and right angle mount
- Extended operating life 50,000 cycles
- Optional caps
- Sealed against soldering and cleaning processes
- RoHS compliant

Typical Applications

- Networking equipment
- Modems
- Reset functions
- Instrumentation

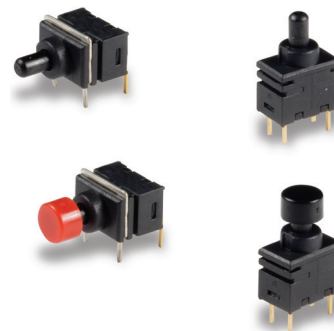

Specifications

CONTACT RATING: Max. 0.4 VA (28 V DC or V AC).
 ELECTRICAL LIFE: 50,000 cycles.
 CONTACT RESISTANCE: (10mA @ 2 V DC) 80 mΩ/105 max. initial.
 INSULATION RESISTANCE: 500MΩ 105min. @ 500 V DC - 1 minute.
 OPERATING TEMPERATURE: -20°105C to 80°105C.
 SOLDERABILITY: Per MIL-STD-202F method 208D, or EIA RS-186E method 9.
 PACKAGING:
 Tray pack - 100 switches per tray.
 Caps (optional) - Bulk bag; 100 caps per bag.

Materials

MOVABLE CONTACTS:
 Base metal: Phosphor bronze
 Plating: Gold over nickel plate
 FIXED CONTACTS:
 Base metal: Brass
 Plating: Gold over nickel plate
 COVER: PA66 - Black
 ACTUATOR: PPS - Black
 BASE: PPS - Black
 SUPPORT BRACKET (A1 Terminal Style only): Steel with tin plate

NOTE: Specifications and materials listed above are for switches with standard options. For information on specific and custom switches, consult Customer Service Center.

Build-A-Switch

To order, simply select desired option from each category and place in the appropriate box. Available options are shown and described on pages A-106 thru A-107. For additional options not shown in catalog, consult Customer Service Center.

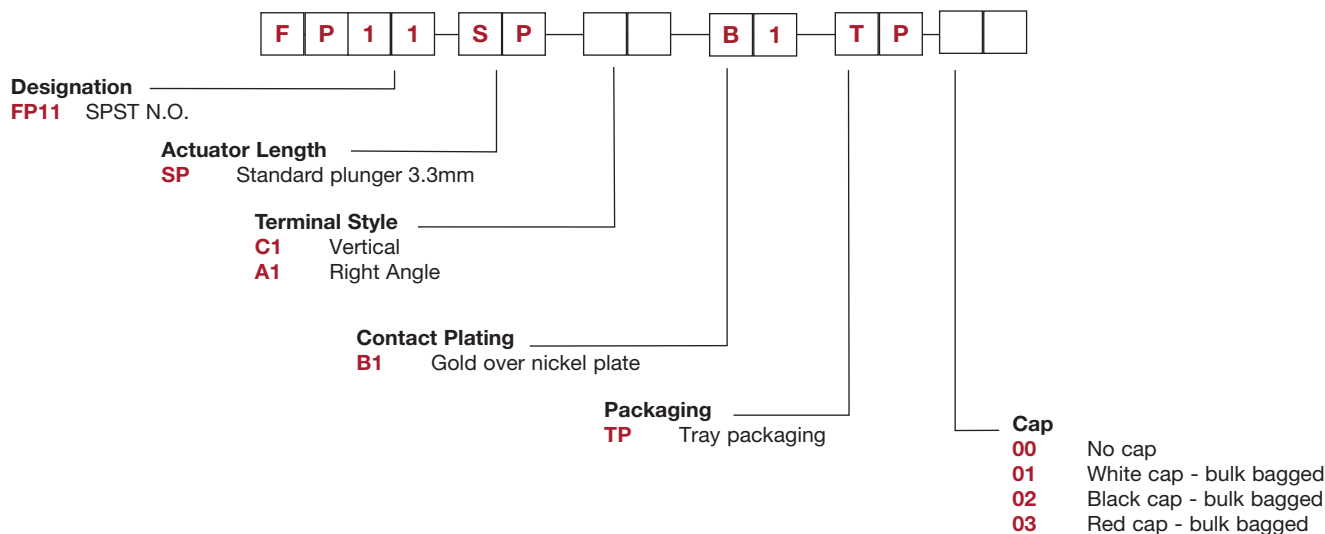

Dimensions are shown: Inches (mm)
 Specifications and dimensions subject to change



FP Series Sealed Ultra Miniature Pushbutton Switches

SWITCH FUNCTION

Pushbutton

C1 VERTICAL

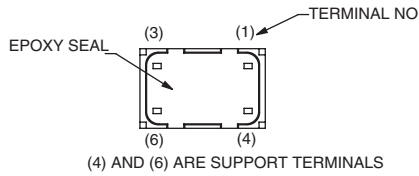
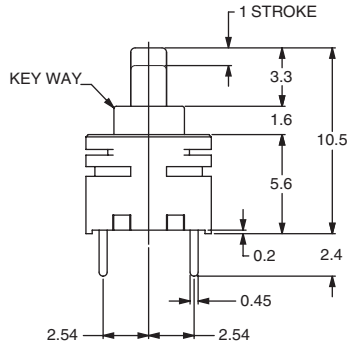
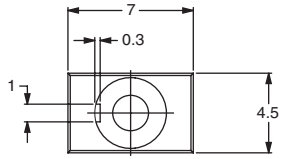

A1 RIGHT ANGLE

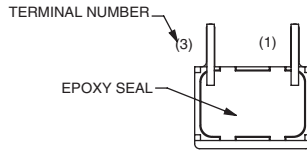
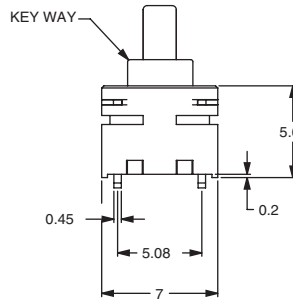
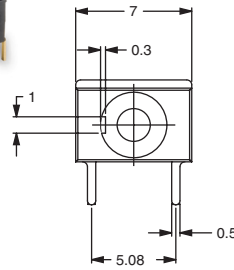

| MODEL NO. | SWITCH FUNCTION | |
|-----------|---------------------|--------|
| | POS. 1 | POS. 2 |
| FP11 | | |
| | CONNECTED TERMINALS | |
| | OPEN | 1-3 |

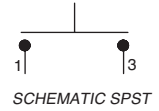

ACTUATOR LENGTH

SP STANDARD PLUNGER 3.3MM

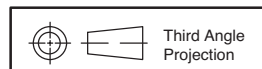
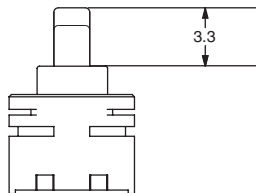

Dimensions are shown: mm
Specifications and dimensions subject to change



FP Series Sealed Ultra Miniature Pushbutton Switches



A Pushbutton

TERMINAL STYLE

C1 VERTICAL

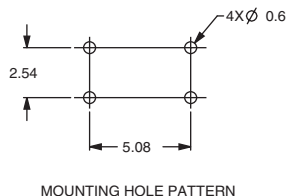
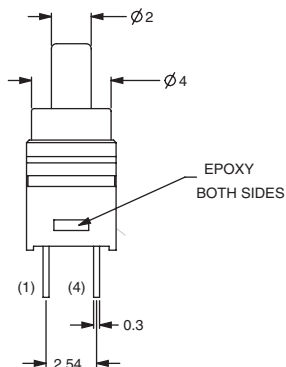

A1 RIGHT ANGLE

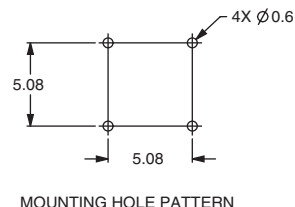
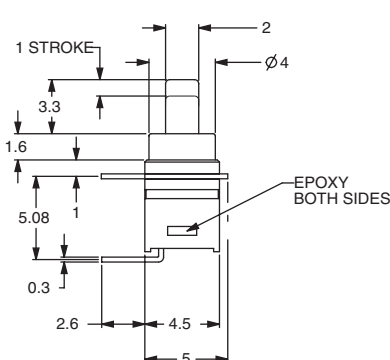

CONTACT PLATING

B1 GOLD OVER NICKEL PLATE

PACKAGING

TP TRAY PACKAGING

CAPS

| OPTION CODE | DESCRIPTION |
|-------------|------------------------|
| 00 | NO CAP |
| 01 | WHITE CAP, BULK BAGGED |
| 02 | BLACK CAP, BULK BAGGED |
| 03 | RED CAP, BULK BAGGED |

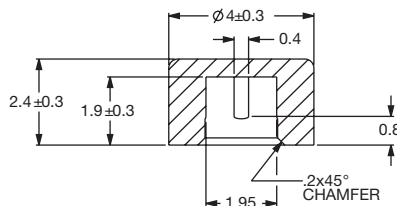

To purchase Caps separately without switch, please use these part numbers

| PART # | COLOR |
|-----------|-------|
| 798D01000 | WHITE |
| 798D02000 | BLACK |
| 798D03000 | RED |

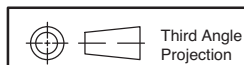

Third Angle Projection

Dimensions are shown: mm
Specifications and dimensions subject to change

