

REMARK:
 1. CHARACTERISTICS:
 RATED VOLTAGE: 250V
 RATED CURRENT: 2.5AMP
 CONTACT RESISTANCE: 25mohms MAX (40mohms MAX FOR AFTER TEST).
 INSULATION RESISTANCE: 5000Mohms MIN. at 500V DC
 DIELECTRIC STRENGTH: 750VRMS
 OPERATING TEMPERATURE RANGE: -55° C~105° C
 INSERTION/EXTRACTION FORCE PER CONTACT: .5N Max./0.2N Min.
 MATING/UNMATING CYCLES: 200MATINGS MIN FOR GOLD-FLASH
 500MATINGS MIN FOR 30u" GOLD.

2. MATERIAL:
 INSULATORS: THERMOPLASTIC G. F.(UL94V-0), BLACK
 CONTACTS: COPPER ALLOY, GOLD(G/F or 30u")TOP OVER CONTACT AREA,
 100u" Min MATTE TIN TOP OVER SOLDER AREA,
 50u" Min NICKEL UNDER PLATE.
 SHELL: CARBON STEEL, 100u" Min NICKEL TOP OVER,
 50u" Min COPPER UNDER PLATE.
 Z BRACKET: COPPER ALLOY, 100u" Min MATTE TIN PLATED.
 SCREW LOCK: COPPER ALLOY , 50u" Min NICKEL PLATED.

3. PART NUMBER DESCRIPTION:
 10090926-P XX X X LF

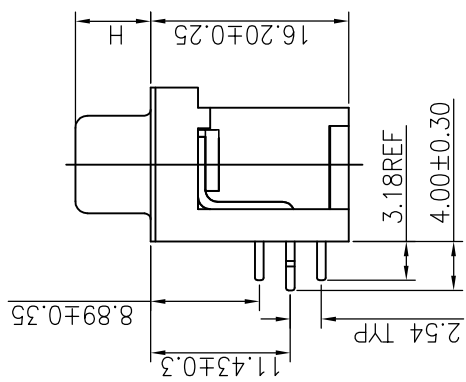
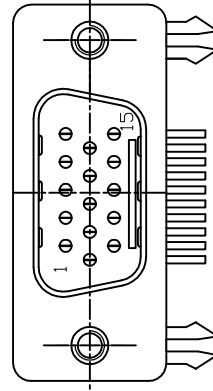
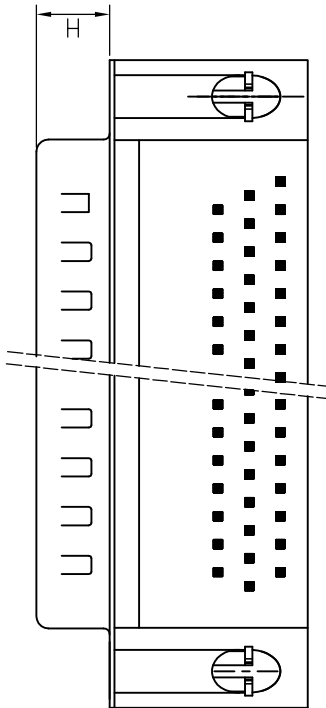
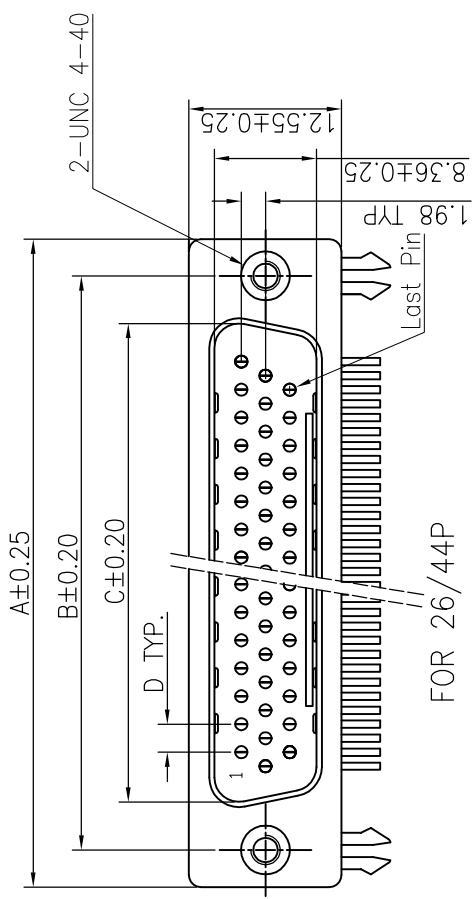
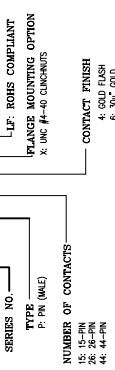

POS.	PART NO.	THREAD TYPE
15P	10090926-P15*XL	UNC #4-40
26P	10090926-P26*XL	UNC #4-40
44P	10090926-P44*XL	UNC #4-40

POS.	A	B	C	D	H
15P	30.81	24.99	16.92	2.29	5.90±0.25
26P	39.24	33.32	25.25	2.29	5.90±0.25
44P	53.04	47.04	38.96	2.29	5.70±0.25

mat'l. code		surface	tolerance	projection	product family
ISO 1302	ISO 406 ISO 1000	ISO 1302	ISO 406 ISO 1000	projection	D-SUB
ISO 1302	ISO 406 ISO 1000	Tolerances unless otherwise specified	Tolerances unless otherwise specified	mm	
angles	linear	linear	linear	scale	1:1
0°±2'	.00±0.25	.00±0.25	.00±0.25	sheet 1 of 3	size
df	MITHUN PAUL 2014/11/22	df	MITHUN PAUL 2014/11/22	Product	Customer Drawing
chr	GREGAR MATHW 2016/12/13	chr	GREGAR MATHW 2016/12/13	dwg no	10090926
appd	BIJU K PAUL 2016/12/13	appd	BIJU K PAUL 2016/12/13	type	
revision	H H H	revision	H H H		
sheet	1 2 3	sheet	1 2 3		
index		index			

AFCI CONFIDENTIAL

Amphenol FCI

This document is the property of and embodies CONFIDENTIAL and PROPRIETARY information of AFCI. No part of the information shown on this document may be used in any way or disclosed to others without the written consent of Amphenol FCI.

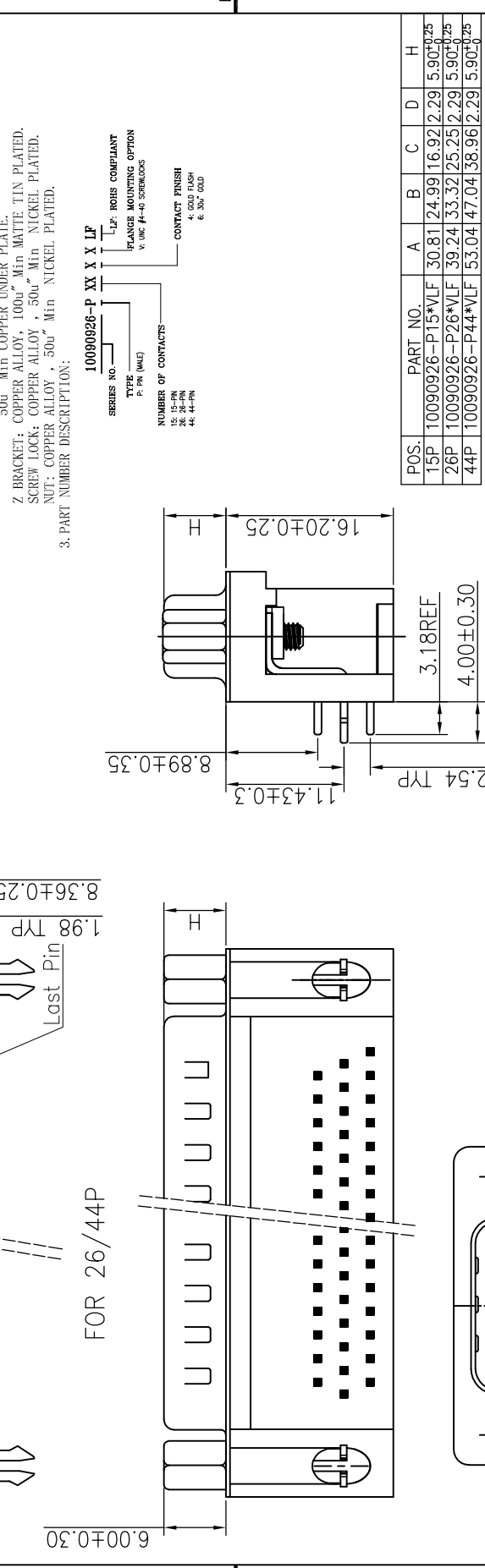
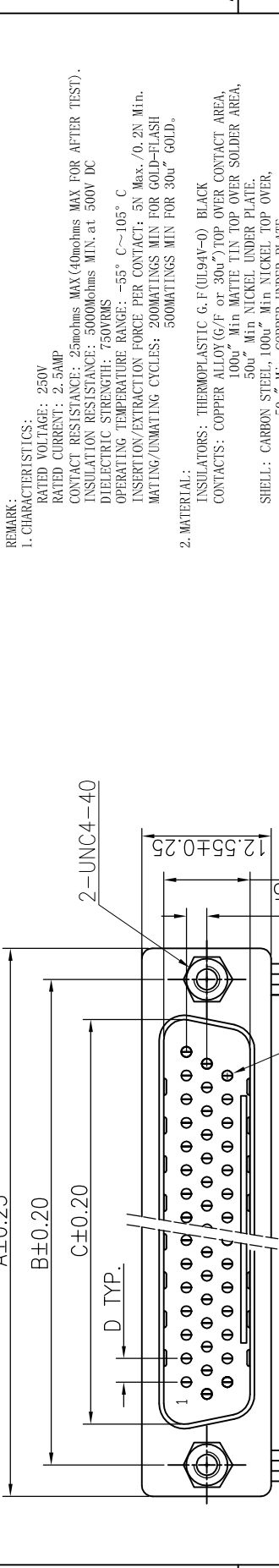

POS.	PART NO.	A	B	C	D	H
15P	10090926-P15*VLF	30.81	24.99	16.92	2.29	5.90±0.25
26P	10090926-P26*VLF	39.24	33.32	25.25	2.29	5.90±0.25
44P	10090926-P44*VLF	53.04	47.04	38.96	2.29	5.90±0.25

mat'l. code	surface	tolerance	projection	product family
	ISO 1302	ISO 406 ISO 100		D-SUB
ltr	ecn no	dr	date	tolerances unless otherwise specified
H	ED-25672	GREGAR	2016/12/13	.0±0.38
				angles linear
				0°±2'
				.000±0.10
				scale 1:1
				sheet 2 of 3 size
				A4
				dwg no 10090926
				Product Customer Drawing
				type

sheet index	revision	H	H	H	H
1	1	2	3	4	5

REMARK:
 1. CHARACTERISTICS:
 RATED VOLTAGE: 250V
 RATED CURRENT: 2.5AMP
 CONTACT RESISTANCE: 25mohms MAX (40mohms MAX FOR AFTER TEST).
 INSULATION RESISTANCE: 5000Mohms MIN. at 500V DC
 DIELECTRIC STRENGTH: 750VRMS
 OPERATING TEMPERATURE RANGE: -55° C~105° C
 INSERTION/EXTRACTION FORCE PER CONTACT: 5N Max./0.2N Min.
 MATING/UNMATING CYCLES: 200MATINGS MIN FOR GOLD-FLASH
 500MATINGS MIN FOR 30u" GOLD.

2. MATERIAL:
 INSULATORS: THERMOPLASTIC G. F.(UL94V-0) BLACK
 CONTACTS: COPPER ALLOY (G/P or 30u") TOP OVER CONTACT AREA,
 100u" Min MATTE TIN TOP OVER SOLDER AREA,
 50u" Min NICKEL UNDER PLATE.
 SHELL: CARBON STEEL, 100u" Min NICKEL TOP OVER,
 50u" Min COPPER UNDER PLATE.
 Z BRACKET: COPPER ALLOY, 100u" Min MATTE TIN PLATED.
 SCREW LOCK: COPPER ALLOY, 50u" Min NICKEL PLATED.
 NUT: COPPER ALLOY, 50u" Min NICKEL PLATED.

3. PART NUMBER DESCRIPTION:
 10090926-P XX X X LP
 LEF: ROHS COMPLIANT
 FLANGE MOUNTING OPTION
 V: 000 #1-#6 SOLDER
 CONTACT FINISH
 4: GOLD FLASH
 6: 30u" GOLD

FCI CONFIDENTIAL

Amphenol FCI

This document is the property of and embodies CONFIDENTIAL and PROPRIETARY information of FCI. No part of the information shown on this document may be used in any way or disclosed to others without the written consent of Amphenol FCI.

form: A3-2016-02-24

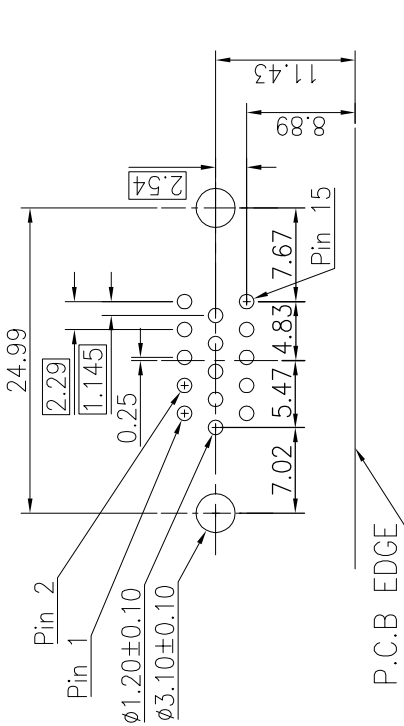

P.C.B LAYOUT (FOR 15P)

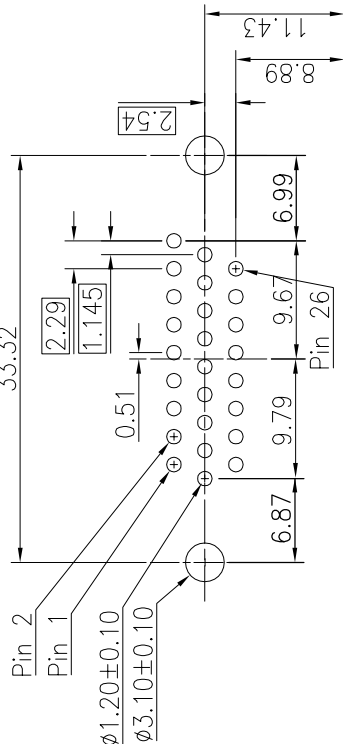

P.C.B LAYOUT (FOR 26P)

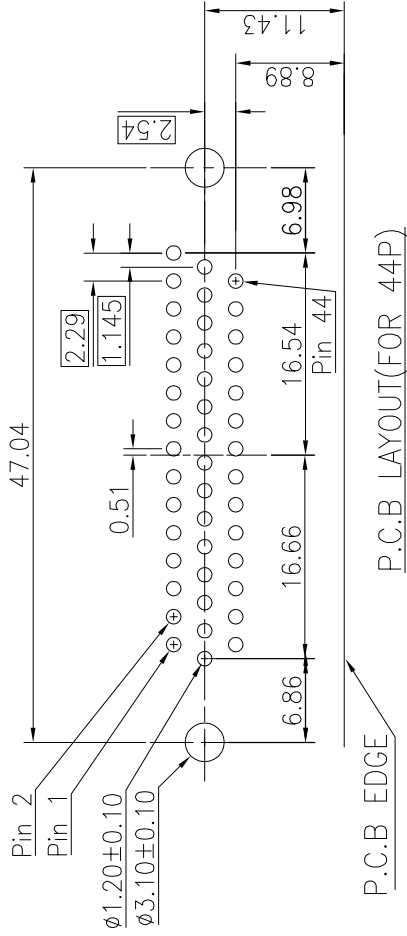

P.C.B LAYOUT (FOR 44P)

mat'l. code	surface	tolerance	projection	product family
	ISO 1302	ISO 406 ISO 1001		D-SUB
ltr	ec'n no	date	title	
H	ED-25612 (REGAR)	2016/12/13	H/D D-SUB MALE RIGHT ANGLE	
	angles	linear	mm	
		.0±0.38		
	linear	.00±0.25	scale	1:1
	0°±2'	.000±0.10		
	dr	MITHUN PAUL 2014/11/22	dwg no	sheet 3 of 3 size
	chr	REGAR MATHW 2016/12/13	Amphenol	A4
	appr	BIJU K PAUL 2016/12/13	FCI	
sheet index	revision	H H	type	Product Customer Drawing
	sheet	1 2 3		