

KRE40-PP

Yoke type track roller

Schaeffler ID:
0055916190000

Stud type track rollers KRE...-PP, with axial guidance, with eccentric collar, plastic axial plain washers on both sides

Technical information

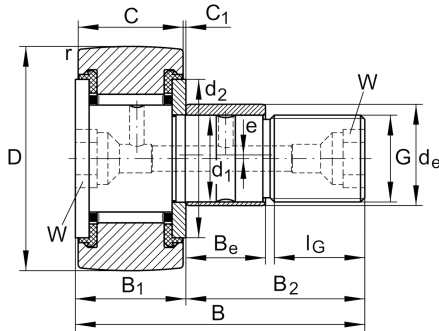

Main Dimensions & Performance Data

D	40 mm	Outside diameter
d ₁	18 mm	Fit diameter of roller stud / stud
B	58 mm	Width
C _{r w}	10,900 N	Basic dynamic load rating, radial
C _{0r w}	16,000 N	Basic static load rating, radial
C _{ur w}	2,130 N	Fatigue load limit, radial
n _{DG}	2,900 1/min	Speed on permanent grease lubrication
	248.7 g	Weight

Dimensions

B ₁	21.6 mm	Width of thrust washer
B ₂	36.5 mm	Bolt/stud length effectively
B ₃	8 mm	Distance to lubrication hole
C	20 mm	Width, outer ring
C ₁	0.8 mm	Protrusion outer ring to thrust washer
r _{min}	1 mm	Minimum chamfer dimension
d ₂	31.5 mm	Stop diameter of thrust washer
d ₃	3 mm	Diameter lubrication hole
G	M18X1,5	Thread
l _G	19 mm	Thread length
W	8 mm	Nominal dimension for hexagonal socket
d _e	22 mm	Diameter of eccentric
B _e	16 mm	Width, eccentric
e	1 mm	Eccentricity

Additional information

	NIPA2X7,5	Drive-fit lubrication nipple
M _A	87 Nm	Tightening torque nut