

CONTROL DRAWING

29976S1-X-XXX

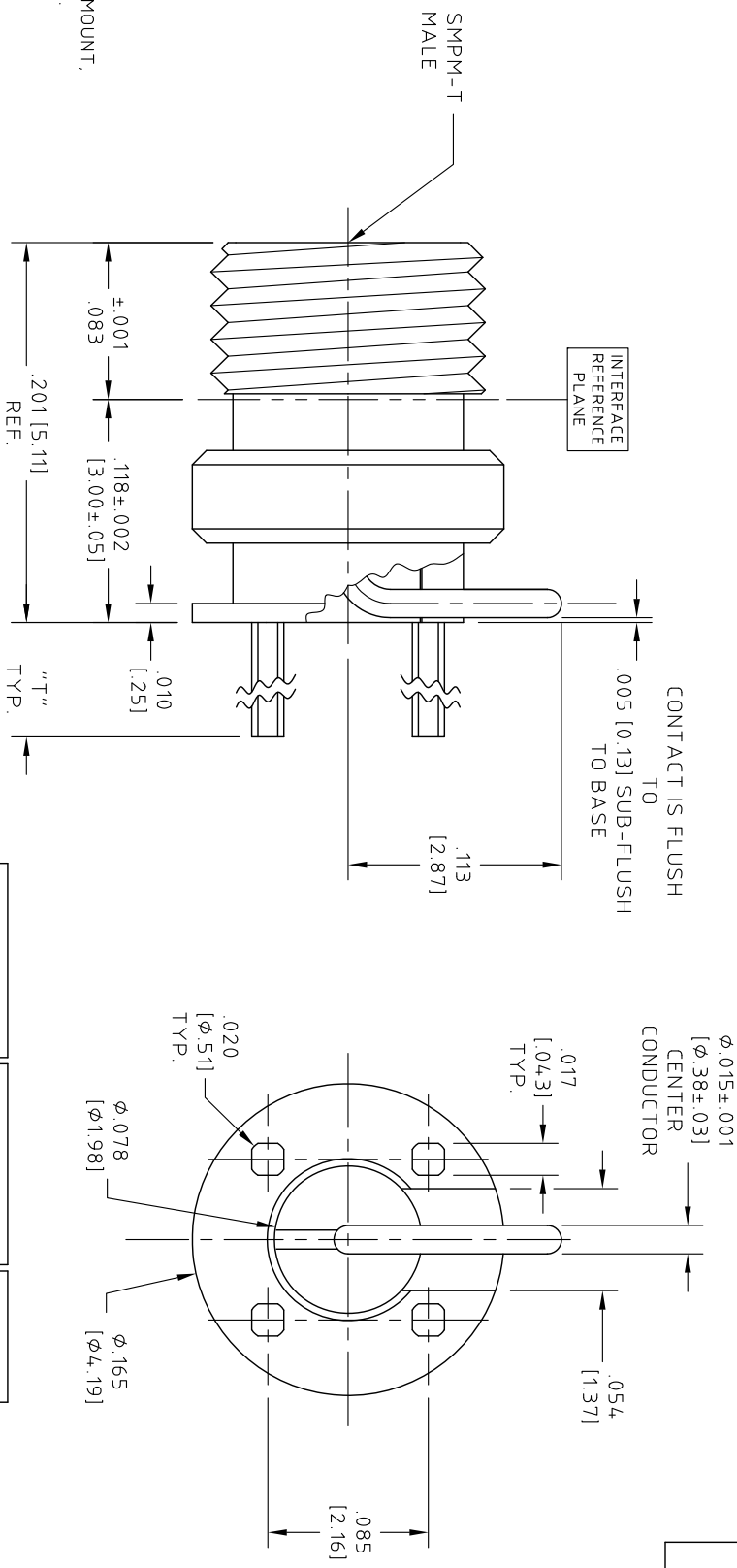

- NOTES:
- DESCRIPTION CONNECTOR, THRU THE BOARD MOUNT, SMPM-T MALE, LAUNCHER.
 - MATERIALS AND FINISHES BODY AND CENTER CONDUCTOR, BERYLLIUM COPPER ALLOY PER ASTM B-196, UNS No. C17300, TEMPER TD04(H), GOLD PLATED .000050 IN (1.27 μM) MIN. THK. PER ASTM B-488, CODE C, TYPE II, CLASS 1.27 OVER NICKEL PLATE .000050 IN (1.27 μM) MIN. THK. PER SAE-AMS-QQ-N-290, TYPE 1. DIELECTRIC, POLYAMIDE-IMIDE (TORLON® 4203) ELECTRICAL GRADE, PER ASTM D-5204.
 - ELECTRICAL CHARACTERISTICS: IMPEDANCE 50.0 Ohms NOMINAL.
 - INTERFACE MEETS MIL-STD-348.
 - OPERATING TEMPERATURE RANGE -55° C TO +125° C
 - MOUNTING PATTERNS CUSTOMER SPECIFIC FACTORS INCLUDING TRANSMISSION LINE TOPOLOGY, SUBSTRATE THICKNESS AND MATERIAL, BOARD-STACKUP, OPERATING FREQUENCY, ETC. MUST BE SUBMITTED TO HUBER+SÜHNER ASTROLAB FOR ANALYSIS PRIOR TO RELEASE OF FINAL PERFORMANCE LEVELS AND MOUNTING CONFIGURATION.

ROHS 6 COMPLIANT

DETENT	PART NUMBER	"T"
FULL DETENT	29976S1-2-106	.106 [2.69]
SMOOTH BORE	29976S1-4-106	.106 [2.69]
FULL DETENT	29976S1-2-140	.140 [3.56]
SMOOTH BORE	29976S1-4-140	.140 [3.56]
FULL DETENT	29976S1-2-165	.165 [4.19]
SMOOTH BORE	29976S1-4-165	.165 [4.19]
FULL DETENT	29976S1-2-200	.200 [5.08]
SMOOTH BORE	29976S1-4-200	.200 [5.08]

REV.	DESCRIPTION	DATE	BY	APPROVED
H	ECN No. 20491	08/27/18	GSG	

UNLESS OTHERWISE SPECIFIED	
CONCENTRICITY	.004 T.I.R.
CORNERS AND FILETS	.005
MAX. RADIUS OR CHAMFER	AS NOTED
SURFACE FINISH	63 RMS
MICROFINISHES OR BETTER	
FRACTIONS	± 1/32
X	± .030
XX	± .015
XXX	± .005
ANGLES	± 1°
DO NOT SCALE DRAWING	

NAME	DATE	TITLE
PREP. EF	06/22/09	CONNECTOR, THRU THE BOARD MOUNT, SMPM-T MALE.
ELEC. RF	06/23/09	
MECH. GSG	06/23/09	
O.C.		



THIS DRAWING CONTAINS PATENTABLE AND PROPRIETARY INFORMATION. THE DESIGN CANNOT BE USED WITHOUT WRITTEN PERMISSION OF HUBER + SÜHNER ASTROLAB.

THDS. TO BE IN ACCORD WITH U.S. DEPT. OF COMMERCE, FEDERAL STANDARDS FOR FEDERAL SERVICES 1950 SUPPL. TO HANDBOOK H 28.	SCALE	CODE IDENT.	DWG NO.	REV
	10:1	16301	29976S1-X-XXX	H