

Receptacle
KS-069 35
Item KS-06935

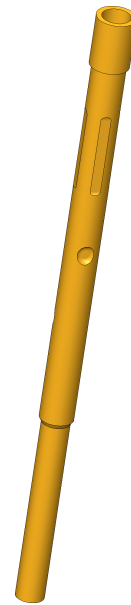

ingun[®]
Partner for Future Technology

INGUN SELECTION



1:1

Receptacle

KS-069 35

Item KS-06935



GO TO PRODUCT

ingun®

Partner for Future Technology

General data

Product group	Receptacles (KS)
Series	KS-069
Sub-series	KS-069 press-in version
Type of receptacle connection	Plug / open
Press ring	No
Surface area	Gold
Collar diameter	1 mm [.039 in]
Collar height	1.35 mm [.053 in]
Knurl	No
Vacuum-tight	No
RoHS-compliant	Yes

Mounting hole

Mounting hole in CEM1	0.85 - 0.86 mm [.033 - .033 in]
Mounting hole in FR4	0.85 - 0.86 mm [.033 - .033 in]

Mechanical data

Total length	16.3 mm [.641 in]
Outer diameter	0.86 mm [.033 in]

INGUN SELECTION

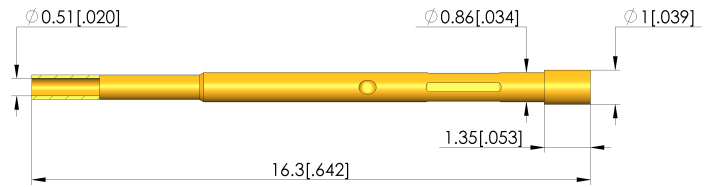

INGUN Prüfmittelbau GmbH

Max-Stromeyer-Straße 162
78467, Constance, Germany
Phone +49 7531 8105-0
Customer hotline +49 7531 8105-888
Fax +49 7531 8105-65
info@ingun.com



Prices and delivery times on request.
Technical changes reserved. 11/22 EN

Weitere Informationen zum Thema
Test probes

