

Pluggable terminal blocks

Screw clamp, DIN 1-3

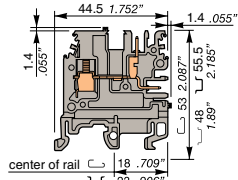

MA 2,5/5.CPE...

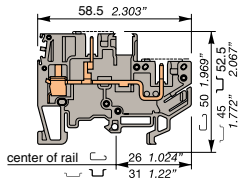

MA 2,5/5.2CPE

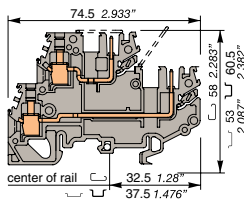

MA 2,5/5D2.2CPE

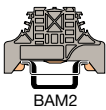

BAM2

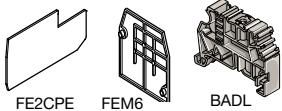

FE2CPE

FEM6

BADL

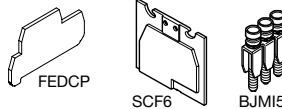

FEDCP

SCF6

BJMI5

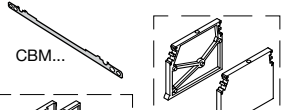

CBM...

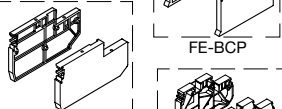

FE1BCP

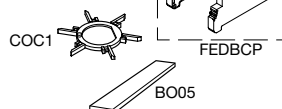

COC1

FEDBCP

BO05

MA 2,5/5.CPE... - 2,5 mm² block - 5.08 mm .200" spacing

Characteristics

		IEC NFC VDE	UL	CSA
Wire size mm ² / AWG	Solid	0.2 - 4 mm ²	24-12 AWG	24-12 AWG
	Stranded	0.22 - 2.5 mm ²		
Voltage	V	320(1)	300	300
Current	A	24/12+12	20/10+10	20/10+10
Rated wire size	mm ² / AWG	2.5 mm ²	12 AWG	12 AWG
Wire stripping length	mm / inches	8.5 mm / .33"		
Recommended torque	Nm / lb.in	0.4-0.6 Nm / 3.5-5.3 lb.in		

MA 2,5/5.2CPE... - 2,5 mm² block - 5.08 mm .200" spacing

Characteristics

		IEC NFC VDE	UL	CSA
Wire size mm ² / AWG	Solid	0.2 - 4 mm ²	24-12 AWG	24-12 AWG
	Stranded	0.22 - 2.5 mm ²		
Voltage	V	320	300	300
Current	A	24/12+12	20/10+10	20/10+10
Rated wire size	mm ² / AWG	2.5 mm ²	12 AWG	12 AWG
Wire stripping length	mm / inches	10 mm / .394"		
Recommended torque	Nm / lb.in	0.4-0.6 Nm / 3.5-5.3 lb.in		

MA 2,5/5D2.2CPE... - 2,5 mm² block - 5.08 mm .200" spacing

Characteristics

		IEC NFC VDE	UL	CSA
Wire size mm ² / AWG	Solid	0.2 - 4 mm ²	24-12 AWG	24-12 AWG
	Stranded	0.22 - 2.5 mm ²		
Voltage	V	320	300	300
Current	A	12/12	10/10	10/10
Rated wire size	mm ² / AWG	2.5 mm ²	12 AWG	12 AWG
Wire stripping length	mm / inches	10 mm / .394"		
Recommended torque	Nm / lb.in	0.4-0.6 Nm / 3.5-5.3 lb.in		

Selection

Description	Type	Order P/N	Packaging	
Standard block grey	<input type="checkbox"/>	MA 2,5/5.CPE	0115 957.12	50
Block equipped with 1 red Led 24V 4,8mA grey	<input type="checkbox"/>	MA 2,5/5.CPE-L24	0115 959.24	50
Block equipped with 1 diode 1N 4007 blue	<input type="checkbox"/>	MA 2,5/5.CPE-D	0125 960.23	50
Standard block grey	<input type="checkbox"/>	MA 2,5/5.2CPE	0115 964.11	50
Standard block blue	<input type="checkbox"/>	MA 2,5/5.2CPE	0125 711.15	50
Double deck block with 2 independant levels grey	<input type="checkbox"/>	MA 2,5/5D2.2CPE	0115 961.16	50
Double deck block with 2 independant levels blue	<input type="checkbox"/>	MA 2,5/5D2.2CPE	0125 961.10	50
Double deck block with 2 connected levels grey	<input type="checkbox"/>	MA 2,5/5D2.2CPE	0115 962.17	50

Accessories

End stop V0	light grey	BADL	9 mm	0399 903.02	(screwless)	50
		BAM2	9.9 mm	0399 967.01	(with screw)	50
End section	grey	<input type="checkbox"/>	FEM6	2.8 mm	0118 368.16	20
		<input type="checkbox"/>	FE2CPE	2.8 mm	0215 038.20	20
		<input type="checkbox"/>	FEDCP	2.54 mm	0215 071.21	20
Separator end section (for MA 2,5/5.CPE... only)	grey	<input type="checkbox"/>	SCF6	3 mm	0118 707.03	20
Assembled jumper bar with IP20 protection		<input type="checkbox"/>	BJMI5	2 poles	0176 278.16	10
		<input type="checkbox"/>	BJMI5	3 poles	0176 279.17	10
		<input type="checkbox"/>	BJMI5	4 poles	0176 280.05	10
		<input type="checkbox"/>	BJMI5	5 poles	0176 281.22	10
		<input type="checkbox"/>	BJMI5	10 poles	0176 282.23	10
Shield connector (for MA 2,5/5.CPE... only)		<input type="checkbox"/>	CBM5	0.5 mm	0168 366.16	50
		<input type="checkbox"/>	CBM8	0.8 mm	0168 367.17	50
End section-flange kit (right + left)		<input type="checkbox"/>	FE-BCP	5.08 mm	0206 391.07	10
		<input type="checkbox"/>	FE1BCP	5.08 mm	0206 389.15	10
		<input type="checkbox"/>	FEDBCP	5.08 mm	0206 392.00	10
Busbar for LED common		<input type="checkbox"/>	BO05	500 mm	0177 849.04	
Coding peg		<input type="checkbox"/>	COC1		0299 777.16	10

Ⓞ Working voltage may vary according to Led