

NO	DESCRIPTION	DATE
△1	MODIFICATION FOR CHASSIS	10.08.98'
△2	BACKGROUND FORMAT UPDATED	06.28.02'
△3	BACKGROUND FORMAT UPDATED ADD SILVER BRAZING	11.05.08'
△4	WORKING VOLTAGE → VOLTAGE RATING DEL. PROOF VOLTAGE	11.27.12'
△5	ADD VSWR	12.30.13'

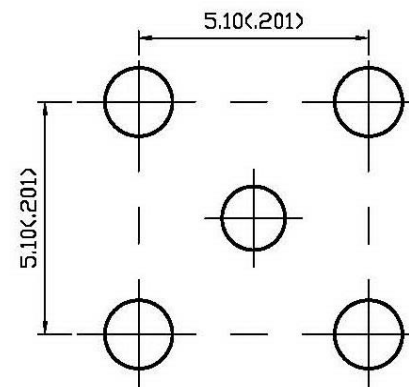
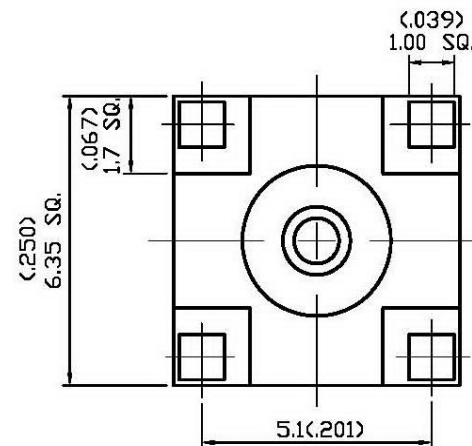
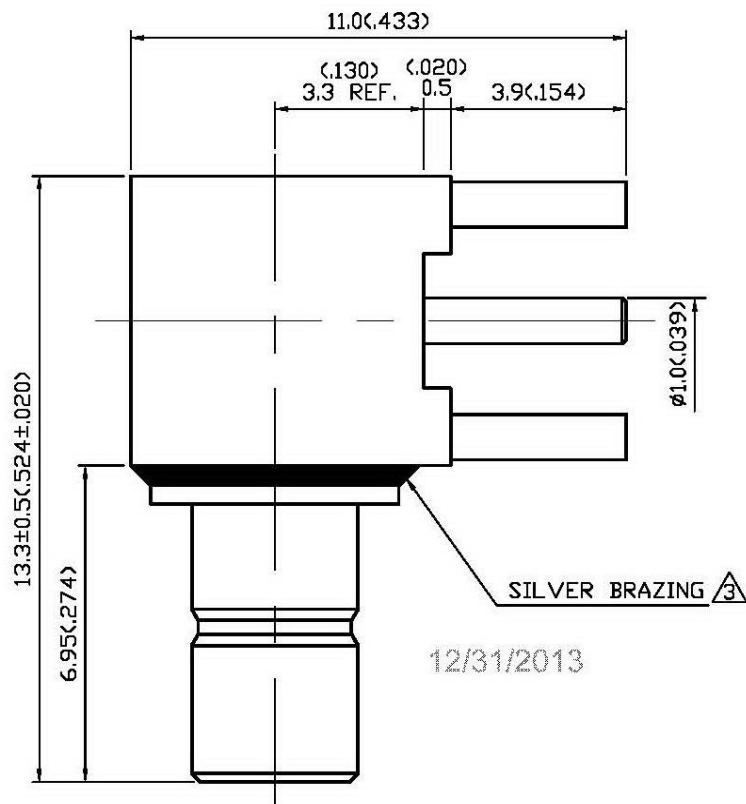

<4> $\phi 1.5<(.059)>$ MIN.
<1> $\phi 1.4<(.055)>$ MIN.

MOUNTING HOLE

12/31/2013

1.0 ELECTRICAL

- 1.1 FREQUENCY RANGE: DC-4 GHz
- 1.2 NOMINAL IMPEDANCE: 50 OHM
- 1.3 VOLTAGE RATING: 335 VOLTS MAX. △4
- 1.4 VSWR: 1.3 MAX. △5

2.0 MATERIALS

- 2.1 BODIES: BRASS PER JIS-C3604
- 2.2 CENTER CONTACT: BRASS PER JIS-C3604
- 2.3 INSULATION: TEFLON PER ASTM D1457 AND ASTM D1710

3.0 FINISHES AND OTHERS

- 3.1 SEE BELOW TABLE FOR DETAILS.

4.0 MECHANICAL

- 4.1 INTERFACE IN ACCORDANCE WITH: MIL-STD-348A

5.0 ENVIRONMENTAL

- 5.1 OPERATING TEMPERATURE RANGE: -85° C TO +185° C

7	CAP	BRASS	1	GOLD 3 μ " MIN.
6	INSULATION	TEFLON	1	NONE
5	INSULATION	TEFLON	1	NONE
4	CENTER CONTACT	BRASS	1	GOLD 30 μ " MIN.
3	CENTER CONTACT	BRASS	1	GOLD 30 μ " MIN.
2	BODY	BRASS	1	GOLD 3 μ " MIN.
1	CHASSIS	BRASS	1	GOLD 3 μ " MIN.
NO	DESCRIPTION	MATERIAL	Q'TY	FINISH



APPROVED

by

DATE:

DESCRIPTION		SMB RIGHT ANGLE PCB MOUNT JACK RECEPTACLE						
製圖	DRAWN	TOLERANCE	品名	24-12-2 T.G.G	日期	DATE	版次	REV.
	Yoko							
檢圖	CHECK	.XX	.XXX	±0.05	單位	SCALE	DWG.NO.	24-0022
	Arc							
認定	APPROVAL	ANGLE	±5°	比例	8:1			
	Angela							