



ES-3308P V3

## 8-Port Fast Ethernet Desktop Switch

The ES-3308P V3 is a 10/100 Mbps unmanaged Ethernet desktop switch designed to enhance network performance. Its compact, sleek design offers outstanding performance and high efficiency, using store and forward packet-switching technology to provide reliable data transfers, ideal for network connectivity in SOHO environments.

To extend home networks or meet streaming, multimedia transfer and online gaming requirements the ES-3308P V3 is a cost-effective Fast Ethernet solution. The plug-and-play design ensures users can easily connect network devices such as PCs, network-attached storage or print servers to a home network with no manual configuration necessary.

### Compact Design & Flexible Placement

Designed for easy home network extension with desktop and wall-mount installation for flexible placement. Its compact size fits into the home environment and keeps desk space free.

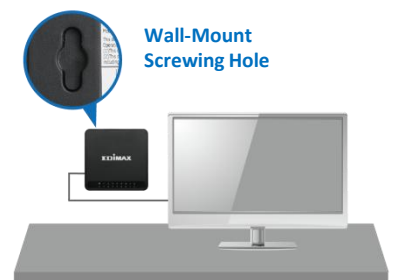

### Easy to Use

The ES-3308P V3 is plug-and-play and supports a wide range of network protocols. Installation and network management is quick and straightforward while clear and convenient LED indicators display easy-to-read port and switch status.

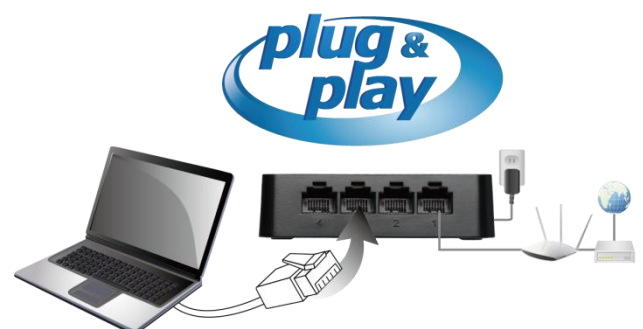

# 8-Port Fast Ethernet Desktop Switch

ES-3308P V3

## High Performance

The ES-3308P V3 switch also supports auto-negotiation and non-blocking wire speed to give you the maximum speed and highest performance possible for each device connected to your network.

### •Auto-Negotiation

Each of the ES-3308P V3's ports automatically detect whether connected network devices are running at 10Mbps or 100Mbps and half-duplex or full-duplex mode, and adjusts the speed and mode accordingly ensuring easy and hassle-free operation.

### •Non-Blocking Wire Speed

Forwards and receives traffic seamlessly – each port supports speeds up to 200Mbps in full-duplex mode simultaneously, providing full wire speed to connected devices and allowing you to run a high speed network smoothly.

## Auto-Negotiation

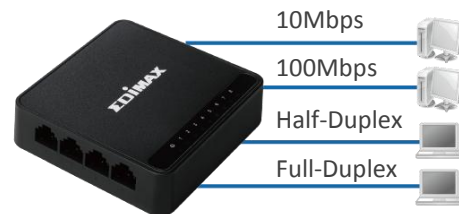

Automatically detect and adjusts the speed and mode

## Non-Blocking Wire Speed

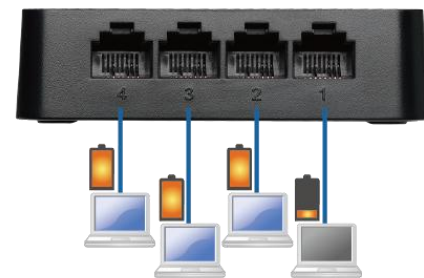

Full-duplex, speeds up to 200Mbps

## Inactive Link Detection

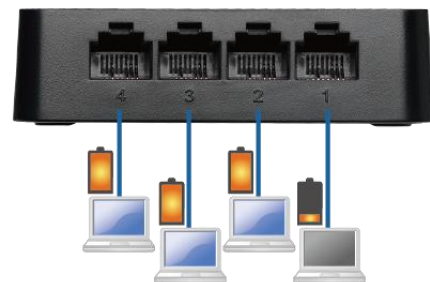

Less power consumption for inactive devices

## Power Saving

Along with the Fast Ethernet speeds critical for next-generation network applications, the ES-3308P V3 offers environmental efficiency. To comply with the IEEE802.3az standard, the ES-3308P V3 provides power saving functionality to reduce energy consumption and save costs:

### •Inactive Link Detection

When a network device is shut down and/or an inactive link is detected, the power usage adjustment feature automatically reduces power usage. The switch's power consumption will be dynamically adjusted according to the link status and the number of active network devices.

### •Cable Length Detection

Devices equipped with this feature automatically detect the length of connected Ethernet cables and adjust power usage accordingly. The shorter the cable length, the less power it consumes.

## Cable Length Detection

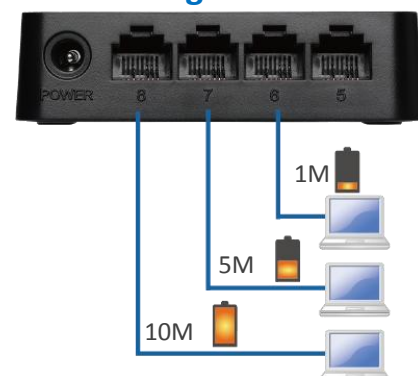

Less power consumption for shorter cables

# 8-Port Fast Ethernet Desktop Switch

**ES-3308P V3**

## FEATURES

- Complies with IEEE802.3, IEEE802.3u standards
- Supports auto MDI/MDI-X crossover detecting and auto correction
- Wire-speed packet filtering and forwarding rate
- Store-and-forward architecture filters fragment & CRC error packets
- Supports IEEE802.3az energy efficient Ethernet function

## TECHNICAL SPECIFICATIONS

Standards	Features	Filtering / Forwarding Rates
<ul style="list-style-type: none"> <li>• IEEE 802.3 10BASE-T</li> <li>• IEEE 802.3u 100BASE-TX</li> <li>• IEEE 802.3x Flow Control</li> <li>• IEEE 802.3az Energy Efficient Ethernet</li> </ul>	<ul style="list-style-type: none"> <li>• RJ-45 Port: 8</li> <li>• MAC Address: 1K</li> <li>• Buffer Memory: 56K</li> <li>• Transmission Method: Store and Forward</li> </ul>	<ul style="list-style-type: none"> <li>• 100Mbps Port – 148,800pps</li> <li>• 10Mbps Port – 14,880pps</li> </ul>
Transmission Media	LED Indicators	Power Requirement
<ul style="list-style-type: none"> <li>• 10BASE-T Cat. 3, 4, 5 UTP/STP</li> <li>• 100BASE-TX Cat. 5 UTP/STP</li> </ul>	<ul style="list-style-type: none"> <li>• Per Port: Link/Act</li> <li>• Per Unit: Power</li> </ul>	<ul style="list-style-type: none"> <li>• DC 5V 0.6A</li> </ul>
Temperature	Humidity	Power Consumption
<ul style="list-style-type: none"> <li>• Operating: 0 to 40°C</li> <li>• Storage: -20 to 70°C</li> </ul>	<ul style="list-style-type: none"> <li>• Operating: 10 to 90% RH (Non-condensing)</li> <li>• Storage: 5 to 90% RH (Non-condensing)</li> </ul>	<ul style="list-style-type: none"> <li>• &lt;2 Watts</li> </ul>
Dimensions	Weight	Certifications
<ul style="list-style-type: none"> <li>• 88 x 88 x 25 mm (L x W x H)</li> </ul>	<ul style="list-style-type: none"> <li>• 86g</li> </ul>	<ul style="list-style-type: none"> <li>• CE</li> <li>• FCC Class B</li> </ul>

## APPLICATION DIAGRAM

- Connect the ES-3308P V3 to your router or cable/xDSL modem
- Connect a print server, NAS, smart TV, laptop, media player, game console and/or IP Camera to the ES-3308P V3.

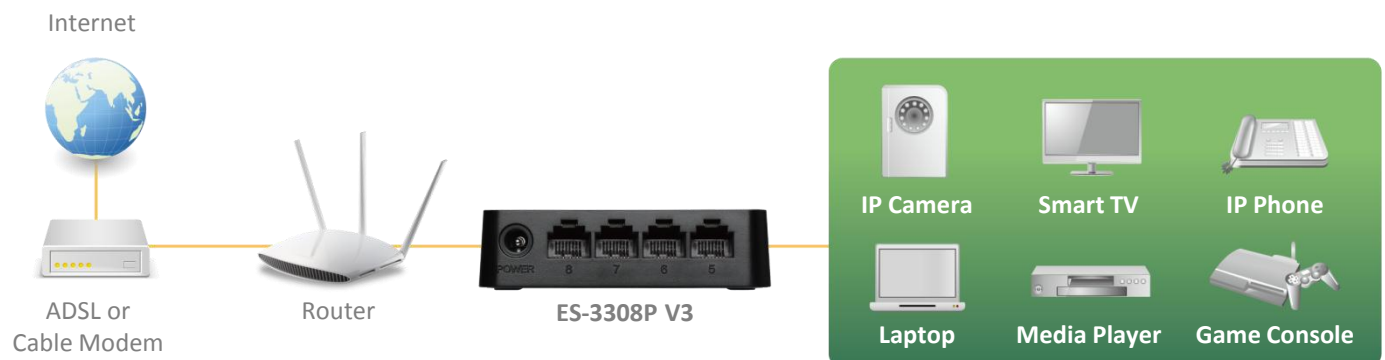

Maximum performance and actual data rates will vary depending on network conditions and environmental factors.

Copyright © 2015 Edimax Technology Co. Ltd. All rights reserved.

www.edimax.com