

BEST CONTACTS FOR YOUR SUCCESS



Telegärtner

KARL GÄRTNER GMBH

NETWORKING COMPONENTS

COAXIAL CONNECTORS

CABLE ASSEMBLIES

PRECISION TURNED PARTS

PLASTIC INJECTION MOULD PARTS

INDUSTRIAL ELECTRONICS



Ready for HDTV?

**75 Ohm Components for HDTV
Series BNC and F**

75 Ohm Components for HDTV - Series BNC and F

The so-called High Definition Television (HDTV) places far higher electrical demands on the 75 Ohm BNC- and F-connectors commonly used, in order to improve the system Return Loss performance and, therefore, the signal reflection, up to a frequency of 3 GHz. For this reason, Telegärtner has specially developed a new series of 75 Ohm BNC- and F-connectors with extremely high impedance matching, resulting in excellent Return Loss values (typically -30 dB min up to 3 GHz). Unlike standard F-connectors, all the Telegärtner designs include a centre contact.



F HDTV Straight Plug



BNC HDTV Straight Plug

BNC and F HDTV Straight Plugs, Crimp/Crimp

| Part number | | | | | | | | | |
|-------------|-------------|-------------|--------------------|-------------------|--------------------|---------------------|--------|------------|----------|
| Plugs | | Cable Group | Inner Cond. Ø [mm] | Dielectric Ø [mm] | Outer Cond. Ø [mm] | Cable Jacket Ø [mm] | Belden | Draka | Bedeia |
| BNC | F | | | | | | | | |
| J01002A0058 | - | G4 | 0.30 +/- 0.05 | 1.50* +/- 0.20 | 2.00 +/- 0.20 | 2.70 +/- 0.30 | 179 DT | | |
| J01002A0018 | J01600A0003 | G41 | 0.60 +/- 0.03 | 2.90* +/- 0.15 | 3.50 +/- 0.10 | 4.70 +/- 0.50 | 1855A | 0.6/2.8 AF | 0.6/2.8C |
| J01002A0055 | J01600A0004 | G39 | 0.80 +/- 0.05 | 3.80* +/- 0.10 | 4.50 +/- 0.10 | 5.90 +/- 0.40 | 1505A | 0.8/3.7 AF | 0.83.7C |
| J01002A0056 | J01600A0005 | G27 | 1.00 +/- 0.02 | 4.65* +/- 0.10 | 5.15 +/- 0.10 | 6.75 +/- 0.25 | 1694A | 1.0/4.8 AF | 1.0/4.8C |
| J01002A0072 | - | G51 | 1.02 +/- 0.02 | 4.65* +/- 0.10 | 5.60 +/- 0.15 | 7.60 +/- 0.25 | 1694F | | |
| J01002A0054 | J01600A0007 | G48 | 1.60 +/- 0.05 | 7.20* +/- 0.20 | 8.10 +/- 0.10 | 10.3 +/- 0.30 | 7731A | 1.6/7.3 AF | 1.6/7.3C |

* = incl. foil

XM Crimp Tool for BNC and F Plugs



XM Crimp Tool

| Part number | Product Description | Cable Group | Crimp Diameter (Hex) | |
|-------------|---|-------------|----------------------|-------------|
| | | | Inner cond. | Outer cond. |
| N00000A0017 | XM Crimp Tool for Interchangeable Dies* | - | | |
| N01003A0009 | Interchangeable Die for J01002A0058 | G4 | 0.80x1.50 | 3.25x8.0 |
| N01003A0039 | Interchangeable Die for J01002A0018 + J01600A0003 | G41 | 1.25x2.50 | 5.41x8.0 |
| N01003A0056 | Interchangeable Die for J01002A0055 + J01600A0004 | G39 / G2 | 1.25x2.50 | 6.48x8.0 |
| N01003A0004 | Interchangeable Die for J01002A0056 + J01600A0005 | G27 / G40 | 1.69x2.50 | 7.01x8.0 |
| N01003J1274 | Interchangeable Die for J01002A0072 | G51 | 1.69x2.50 | 8.23x8.0 |
| N01003D1274 | Interchangeable Die for J01002A0054 + J01600A0007 | G48 | 2.54x2.30 | 10.90x10.0 |

* = Interchangeable dies must be ordered separately

BNC and F HDTV Adaptors



BNC Adaptor

F Adaptor

| Part number | Adaptor Type | Panel Piercing |
|-------------|--|----------------|
| J01005A0006 | BNC Adaptor (f-f) | - |
| J01005A0007 | BNC Bulkhead Adaptor (f-f) | Z04 |
| J01005A0008 | BNC Bulkhead Adaptor with Insulated Flange (f-f) | Z04 |
| J01602A0000 | F Adaptor (f-f) | Z02 |

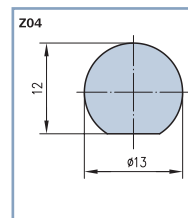
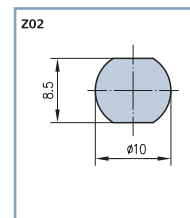

BNC and F 19" Patch Panels Economy V



BNC Patch Panel

| Part number | Product Description | Panel Piercing |
|-------------|--|----------------|
| H02030A0451 | Patch Panel 1 HU for 16 BNC Bulkhead Adaptors (1x16) | Z04 |
| H02030A0452 | Patch Panel 1 HU for 24 BNC Bulkhead Adaptors (2x12) | Z04 |
| H02031A0067 | Patch Panel 2 HU for 48 BNC Bulkhead Adaptors (3x16) | Z04 |
| H02031A0068 | Patch Panel 2 HU for 64 BNC Bulkhead Adaptors (4x16) | Z04 |
| H02030A0459 | Patch Panel 1 HU for 24 F Bulkhead Adaptors (2x12) | Z02 |
| U01100A0010 | Installation of the Bulkhead Adaptors in the Patch Panel | |

i The BNC and F bulkhead adaptors for the patch panels must be ordered separately, and can be factory installed, if required. Front plates with different mounting hole patterns are available.