



# RS-360/365SA

Carbon-brush motors

Output: APPROX 1.0~35W

## Typical Applications

- Toys and Models
- Radio Control Model
- Household Appliances
- Hair Dryer



MODEL	VOLTAGE		NO LOAD		AT MAXIMUM EFFICIENCY				STALL	
	OPERATING RANGE	NOMINAL	SPEED (r/min)	CURRENT (A)	SPEED (r/min)	CURRENT (A)	TORQUE (g.cm)	OUTPUT (W)	CURRENT (A)	TORQUE (g.cm)
RS-360SA-10500	20~30	24V CONSTANT	6600	0.06	5140	0.21	47.4	2.5	0.75	215
RS-360SA-2885	6.0~9.0	7.2V CONSTANT	12100	0.36	10190	1.93	62.2	6.5	10.3	395
RS-365SA-10200	12~24	18V CONSTANT	7800	0.09	5580	0.23	35.5	2	0.59	125
RS-365SA-2080	9.0~18.0	12V CONSTANT	10700	0.3	8370	1.08	67.5	5.8	3.9	310

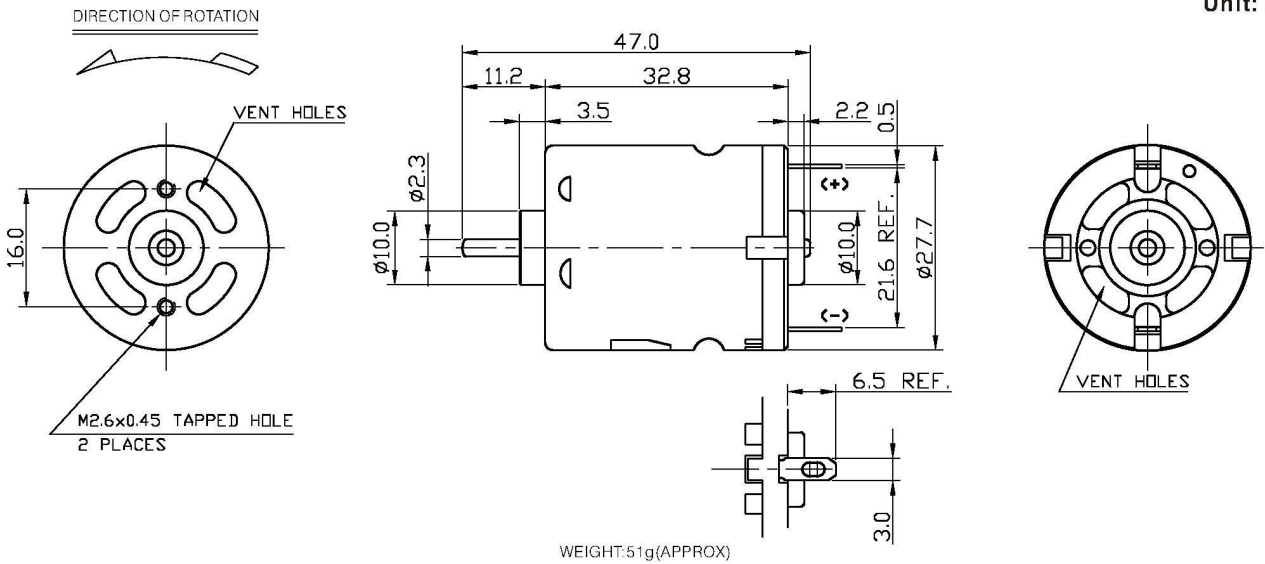

### RS-360SA-10500

24V

### RS-365SA-10200

18V

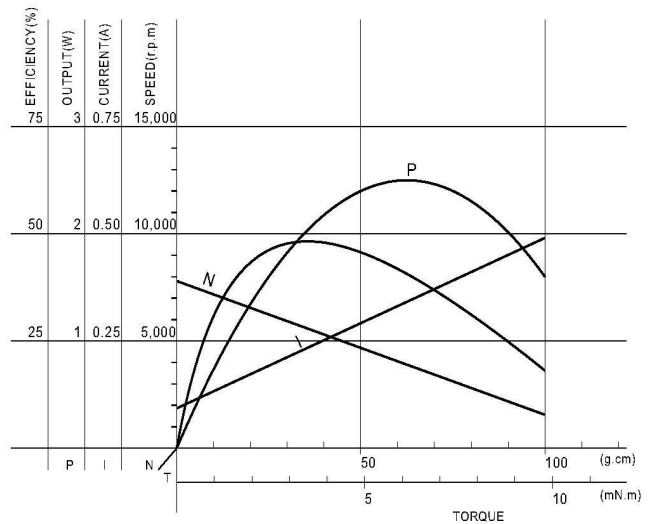
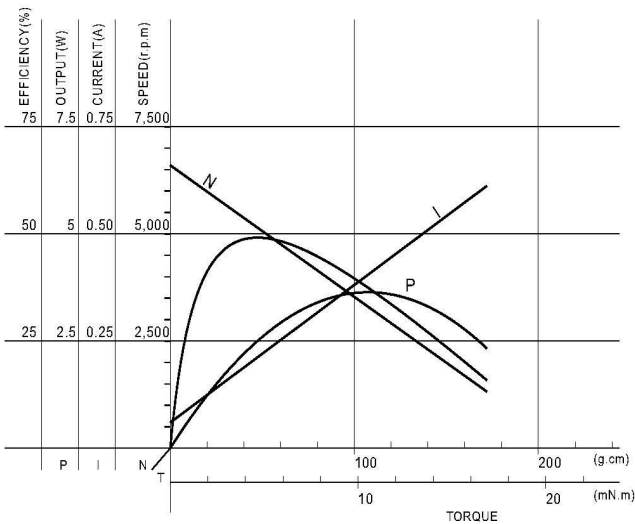

- FA
- FC
- FF
- FK
- FX
- RE
- RC
- RF
- RK
- RS**
- RX
- PL