

Comfort series  
5 mm embeddable

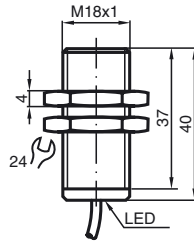

| General specifications            |                               |
|-----------------------------------|-------------------------------|
| Switching element function        | DC Make function              |
| Rated operating distance $s_n$    | 5 mm                          |
| Installation                      | embeddable                    |
| Assured operating distance $s_a$  | 0 ... 4.05 mm                 |
| Reduction factor $r_{Al}$         | 0.37                          |
| Reduction factor $r_{Cu}$         | 0.33                          |
| Reduction factor $r_{V2A}$        | 0.7                           |
| Nominal ratings                   |                               |
| Operating voltage $U_B$           | 5 ... 60 V                    |
| Switching frequency $f$           | 0 ... 350 Hz                  |
| Hysteresis $H$                    | 1 ... 10 typ. 5 %             |
| Reverse polarity protection       | tolerant                      |
| Short-circuit protection          | pulsing                       |
| Voltage drop $U_d$                | $\leq 5$ V                    |
| Operating current $I_L$           | 2 ... 100 mA                  |
| Off-state current $I_r$           | 0 ... 0.5 mA typ.             |
| Indication of the switching state | all direction LED, yellow     |
| Standard conformity               |                               |
| Standards                         | EN 60947-5-2:2004             |
| Ambient conditions                |                               |
| Ambient temperature               | -25 ... 70 °C (248 ... 343 K) |
| Mechanical specifications         |                               |
| Connection type                   | 2 m, PUR cable                |
| Cable version                     | PA                            |
| Core cross-section                | 0.34 mm <sup>2</sup>          |
| Housing material                  | Stainless steel               |
| Sensing face                      | PBT                           |
| Protection degree                 | IP67                          |

### Connection type:

Z0

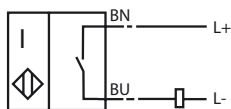

Comfort series  
5 mm embeddable

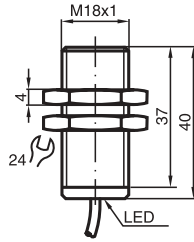

| Switching element function        | DC                            | Break function |
|-----------------------------------|-------------------------------|----------------|
| Rated operating distance $s_n$    | 5 mm                          |                |
| Installation                      | embeddable                    |                |
| Assured operating distance $s_a$  | 0 ... 4,05 mm                 |                |
| Reduction factor $r_{Al}$         | 0,37                          |                |
| Reduction factor $r_{Cu}$         | 0,33                          |                |
| Reduction factor $r_{V2A}$        | 0,7                           |                |
| Operating voltage $U_B$           | 5 ... 60 V                    |                |
| Switching frequency $f$           | 0 ... 350 Hz                  |                |
| Hysteresis $H$                    | 1 ... 10 typ. 5 %             |                |
| Reverse polarity protection       | tolerant                      |                |
| Short circuit protection          | pulsing                       |                |
| Voltage drop $U_d$                | $\Omega$ 5 V                  |                |
| Operating current $I_L$           | 2 ... 100 mA                  |                |
| Off-state current $I_r$           | 0 ... 0,5 mA typ.             |                |
| Indication of the switching state | all direction LED, yellow     |                |
| Standards                         | EN 60947-5-2                  |                |
| Ambient temperature               | -25 ... 70 °C (248 ... 343 K) |                |
| Connection type                   | 2 m, PUR cable                |                |
| Cable version                     | PA                            |                |
| Core cross-section                | 0.34 mm <sup>2</sup>          |                |
| Housing material                  | high grade steel              |                |
| Sensing face                      | PBT                           |                |
| Protection degree                 | IP67                          |                |

### Connection\_type:

Z1

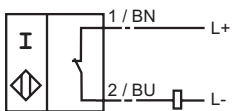

089262\_ENG.xml

2003-07-08