

NPN General Purpose Amplifier

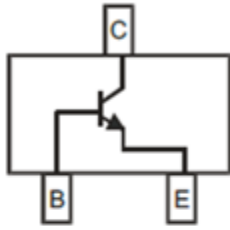

SOT-23

Features

- Epoxy meets UL-94 V-0 flammability rating and halogen free
- Moisture Sensitivity Level 1
- Part no. with suffix "Q" means AEC-Q101 qualified

Mechanical Data

- **Case:** SOT-23
- **Terminals:** Tin plated leads, solderable per J-STD-002 and JESD22-B102
- **Marking:**

| | Marking |
|-----------|---------|
| BC817-16Q | 6A |
| BC817-25Q | 6B |
| BC817-40Q | 6C |

■ Maximum Ratings (Ta=25°C unless otherwise noted)

| Item | Symbol | Unit | Value |
|--|------------|------|-------------|
| Collector-Emitter Voltage | V_{CEO} | V | 45 |
| Collector-Base Voltage | V_{CBO} | V | 50 |
| Emitter-Base Voltage | V_{EBO} | V | 5 |
| Collector Current -Continuous | I_C | mA | 500 |
| Total Device Dissipation (*) | P_D | mW | 300 |
| Thermal Resistance Junction to Ambient (*) | R_{thJA} | K/W | 417 |
| Junction Temperature | T_j | °C | -55 to +150 |
| Storage Temperature | T_{STG} | °C | -55 to +150 |

(*) Device mounted on FR-4 PCB 1.0 x 1.0 x 0.06 inch.



BC817-16Q THRU BC817-40Q

RoHS
COMPLIANT

■ Off Characteristics (Ta=25°C unless otherwise noted)

| Item | Symbol | Unit | Conditions | Min | Max |
|-------------------------------------|-----------|---------------|-----------------------------------|-----|-----|
| Collector-emitter breakdown voltage | V_{CEO} | V | $I_C = 10\text{mA}, I_B = 0$ | 45 | - |
| Collector-base breakdown voltage | V_{CBO} | V | $I_C = 10\mu\text{A}, I_E = 0$ | 50 | - |
| Emitter-base breakdown voltage | V_{EBO} | V | $I_E = 1.0\mu\text{A}, I_C = 0$ | 5.0 | - |
| Emitter cut-off current | I_{EBO} | μA | $V_{EB} = 4.0\text{Vdc}, I_C = 0$ | - | 0.1 |
| Collector cut-off current | I_{CBO} | μA | $V_{CB} = 45\text{Vdc}, I_E = 0$ | - | 0.1 |

■ On Characteristics (Ta=25°C unless otherwise noted)

| Item | Symbol | Unit | Conditions | Min | Max |
|--------------------------------------|---------------|------|--|-----|-----|
| DC Current Gain | h_{FE} | - | $I_C = 100\text{mA}, V_{CE} = 1.0\text{Vdc}$ | 100 | 250 |
| | | | | 160 | 400 |
| | | | | 250 | 600 |
| DC Current Gain | h_{FE} | - | $I_C = 500\text{mA}, V_{CE} = 1.0\text{Vdc}$ | 40 | - |
| Collector-emitter Saturation Voltage | $V_{CE(sat)}$ | V | $I_C = 500\text{mA}, I_B = 50\text{mA}$ | - | 0.7 |
| Base-emitter Saturation Voltage | $V_{BE(sat)}$ | V | $I_C = 500\text{mA}, I_B = 50\text{mA}$ | - | 1.2 |

■ Small-signal Characteristics (Ta=25°C unless otherwise noted)

| Item | Symbol | Unit | Conditions | Min | Max |
|--------------------------------|--------|------|--|-----|-----|
| Current Gain-bandwidth Product | f_T | MHz | $I_C = 10\text{mA}, V_{ce} = 5.0\text{Vdc}, f = 100\text{MHz}$ | 100 | - |

■ Ordering Information (Example)

| PREFERRED P/N | PACKING CODE | UNIT WEIGHT(g) | MINIMUM PACKAGE(pcs) | INNER BOX QUANTITY(pcs) | OUTER CARTON QUANTITY(pcs) | DELIVERY MODE |
|--------------------------|--------------|------------------|----------------------|-------------------------|----------------------------|---------------|
| BC817-16Q THRU BC817-40Q | F2 | Approximate 0.01 | 3000 | 30000 | 120000 | 7" reel |



■ Characteristics (Typical)

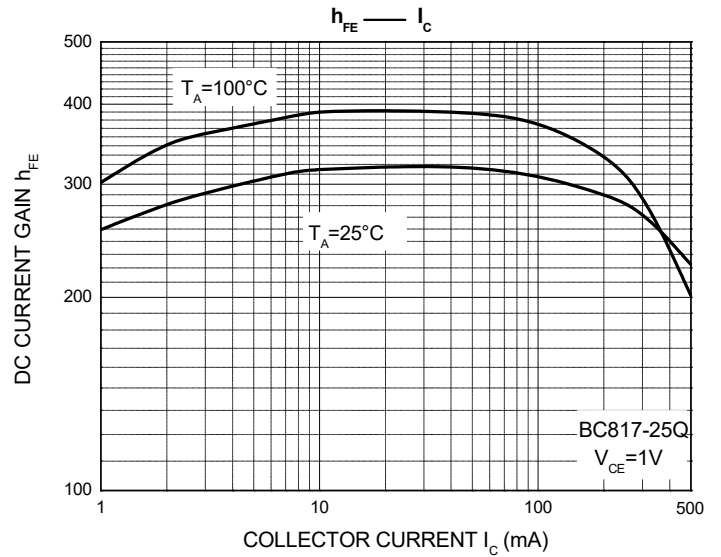
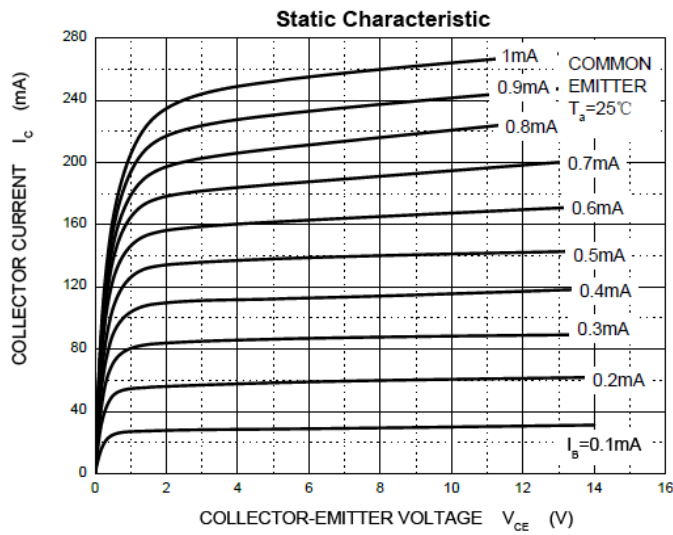
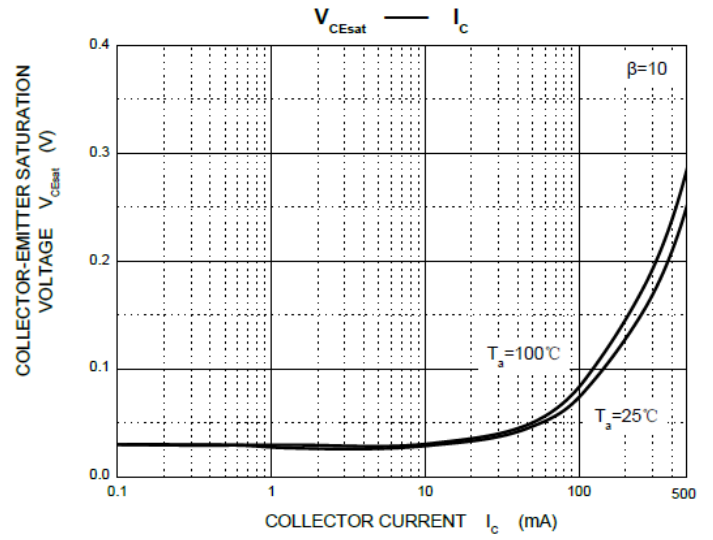
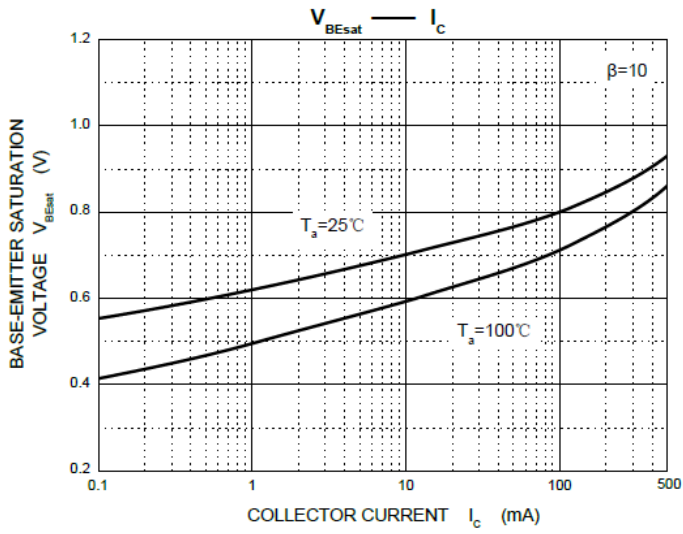

■ SOT-23 Package Outline Dimensions

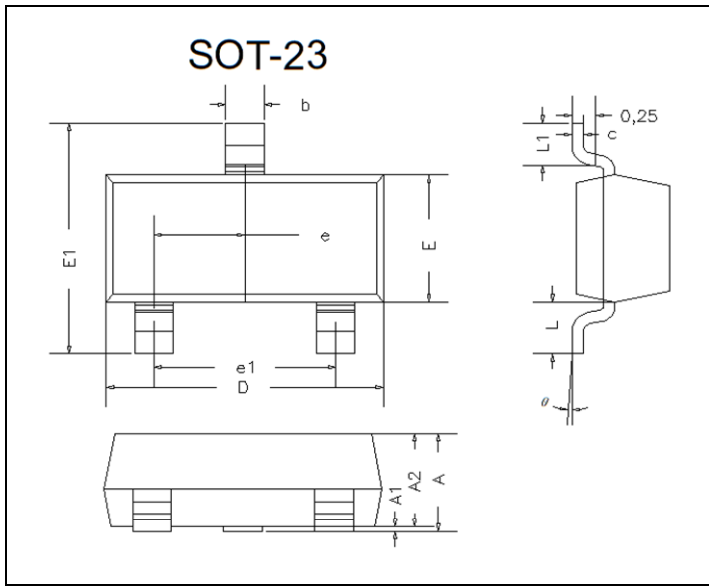

| DIM | INCHES | | MM | | NOTE |
|-----|----------|-------|---------|------|------|
| | MIN | MAX | MIN | MAX | |
| A | 0.035 | 0.045 | 0.90 | 1.15 | |
| A1 | 0.000 | 0.004 | 0.00 | 0.10 | |
| A2 | 0.035 | 0.041 | 0.90 | 1.05 | |
| b | 0.012 | 0.020 | 0.30 | 0.50 | |
| c | 0.004 | 0.008 | 0.10 | 0.20 | |
| D | 0.110 | 0.118 | 2.80 | 3.00 | |
| E | 0.047 | 0.055 | 1.20 | 1.40 | |
| E1 | 0.089 | 0.100 | 2.25 | 2.55 | |
| e | 0.370TYP | | 0.95TYP | | |
| e1 | 0.071 | 0.079 | 1.80 | 2.00 | |
| L | 0.220REF | | 0.55REF | | |
| L1 | 0.012 | 0.020 | 0.30 | 0.50 | |
| θ | 0° | 8° | 0° | 8° | |

■ SOT-23 Suggested Pad Layout

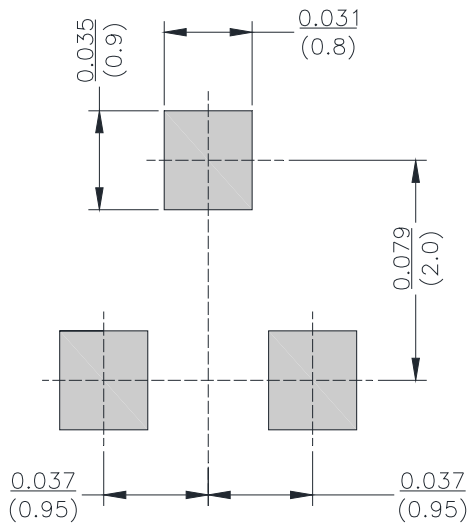

Unit: $\frac{\text{inch}}{\text{mm}}$



■ Marking Information

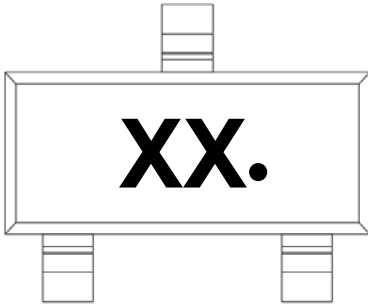

Note:

1. All marking is at middle of the product body
2. All marking is in laser marking
3. XX is Marking Code determined by specific model
4. Body color: Black



Disclaimer

The information presented in this document is for reference only. Yangzhou Yangjie Electronic Technology Co., Ltd. reserves the right to make changes without notice for the specification of the products displayed herein to improve reliability, function or design or otherwise.

The product listed herein is designed to be used with automotive electronics, are not designed for use in medical, life-saving, life-sustaining, or military, Yangjie or anyone on its behalf, assumes no responsibility or liability for any damages resulting from such improper use of sale.

This publication supersedes & replaces all information previously supplied. For additional information, please visit our website [http:// www.21yangjie.com](http://www.21yangjie.com) , or consult your nearest Yangjie's sales office for further assistance.